

PROGRAM +DIAGRAM

INTRODUCTION

Main Goal...

To create a dream house for my clients depending on their needs and hobbies . To create a open plan which allows a smooth circulation for people, light, and ventilation . Also, putting in consideration the surroundings of the house, and how to integrate it with the house .

Dominant features...

Sense of privacy when entering the house . A big kitchen with smooth circulation . Kitchen connected to the other rooms since it is one of the most important features of the house . Space for dogs, making them part of the family . Studio that can serve as a gallery as well .

Crucial aspects...

Create landscape that will work as a barrier to do not allow noise and light (just a good amount) coming into the house .

PROGRAM

- 1) BASED ON ACTIVITIES:
Space for a Studio (Art Gallery)
Big kitchen and pantry room
Space for wine collection
Food Garden
- 2) DESIGN CONSIDERATIONS
Space for dogs (Room, bathing, and eating area)
Closed entry
- 3) NECESSITIES:
Breakfast Room
Mud Room
Laundry Room
Garage
Living Room
Dining Room
2+1 /2 Bathrooms
Master Bedroom
Walk in Closet
Guest Room
Closet

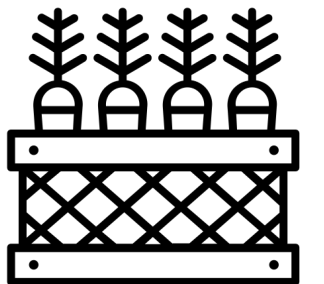
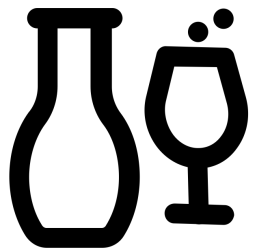
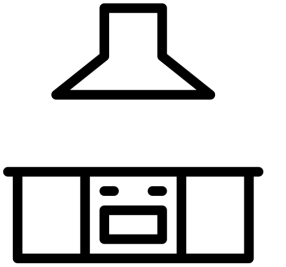

ADJACENCY DIAGRAM

HIERARCHY

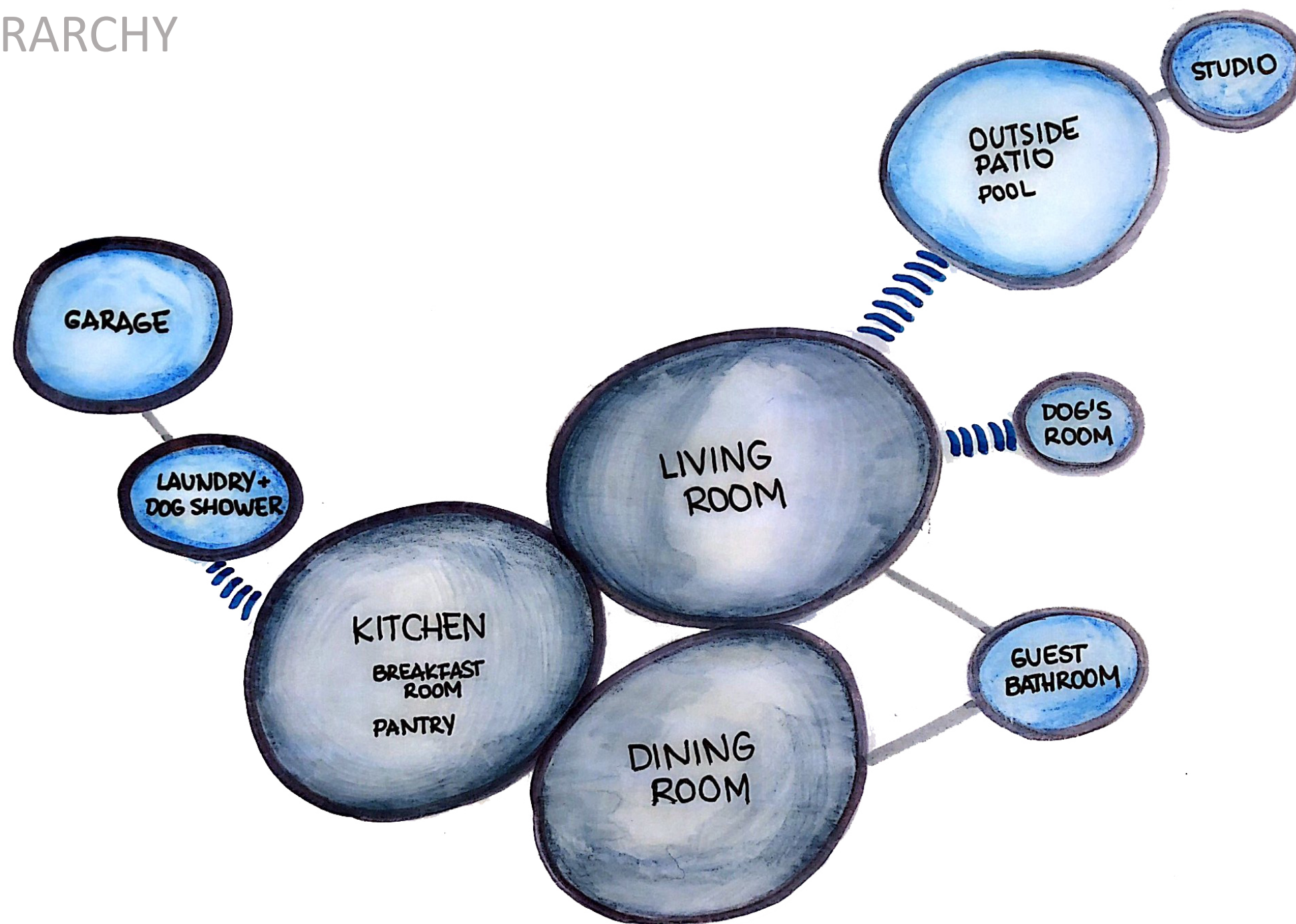

On this adjacency diagram, the hierarchy of the areas are being show . The sizes of the bubbles represent the proportion of the areas .

FIRST FLOOR

Larger Areas

Smaller Areas

Primary Areas

Secondary Areas



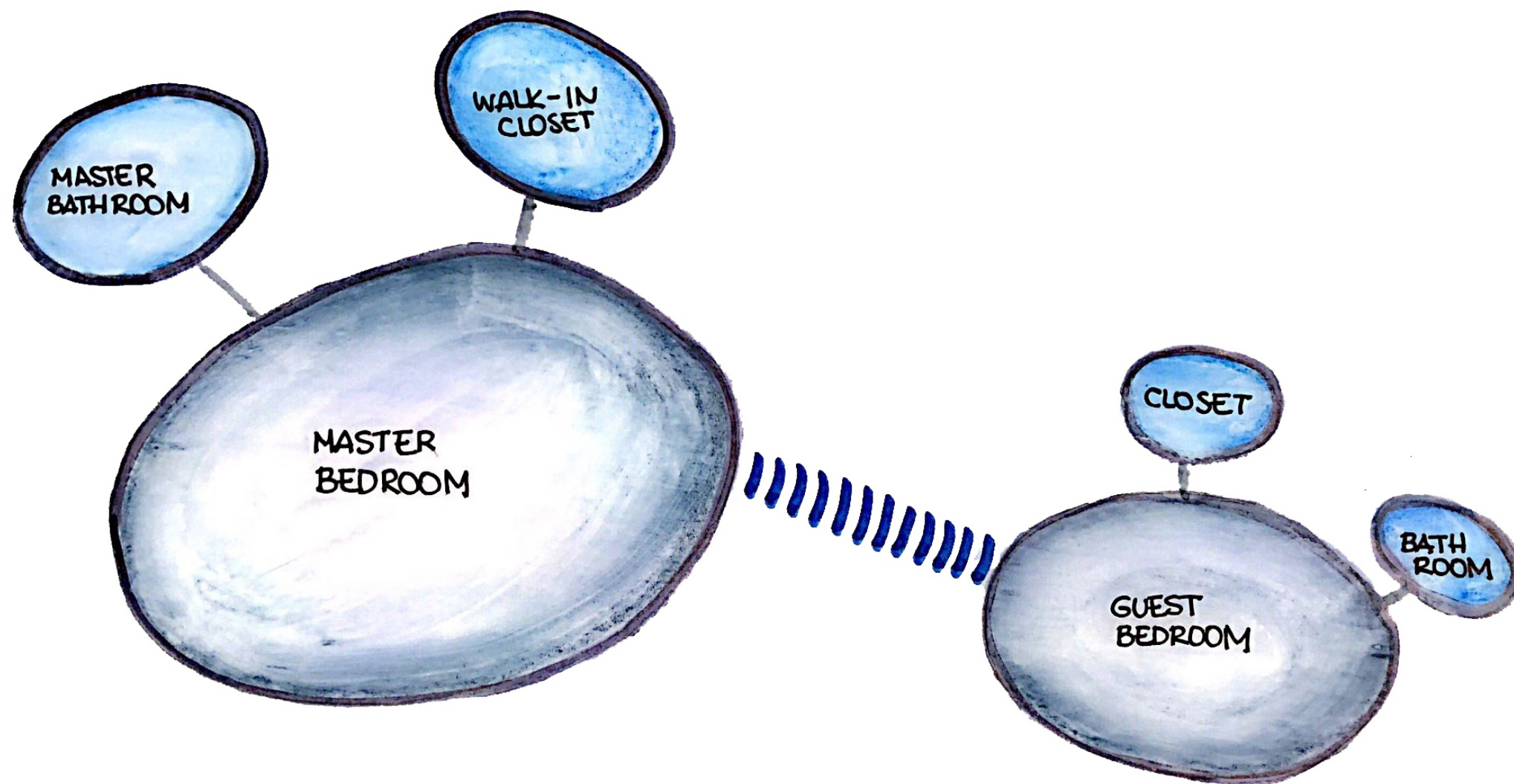

ADJACENCY DIAGRAM

HIERARCHY



On this adjacency diagram, the hierarchy of the areas are being show . The sizes of the bubbles represent the proportion of the areas .

SECOND FLOOR

Larger Areas	
Smaller Areas	
Primary Areas	
Secondary Areas	

ADJACENCY DIAGRAM

PUBLIC /PRIVATE

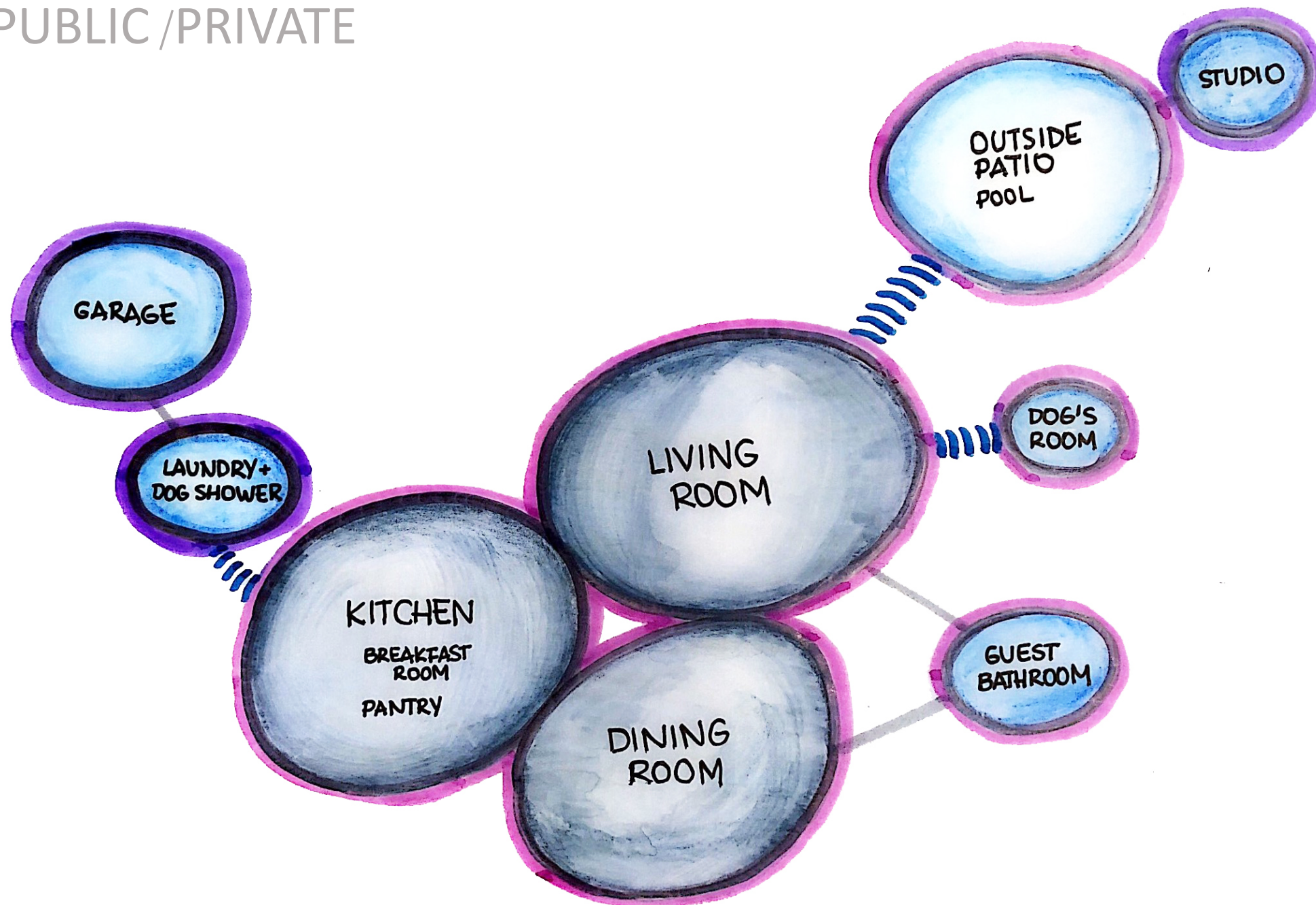

The first floor is a union of public and private places since it is the first area where the guest finds him /herself after entering the house .

The color pink represents the public areas of the house, such as the Kitchen, Living Room, Dining Room, Guest Bathroom, Dog's Room, Pool, and Outside Patio .

The color purple represents the private areas such as the Laundry Room, Dog Shower, Garage, and Studio .

FIRST FLOOR

Public Areas

Private Areas

ADJACENCY DIAGRAM

PUBLIC /PRIVATE

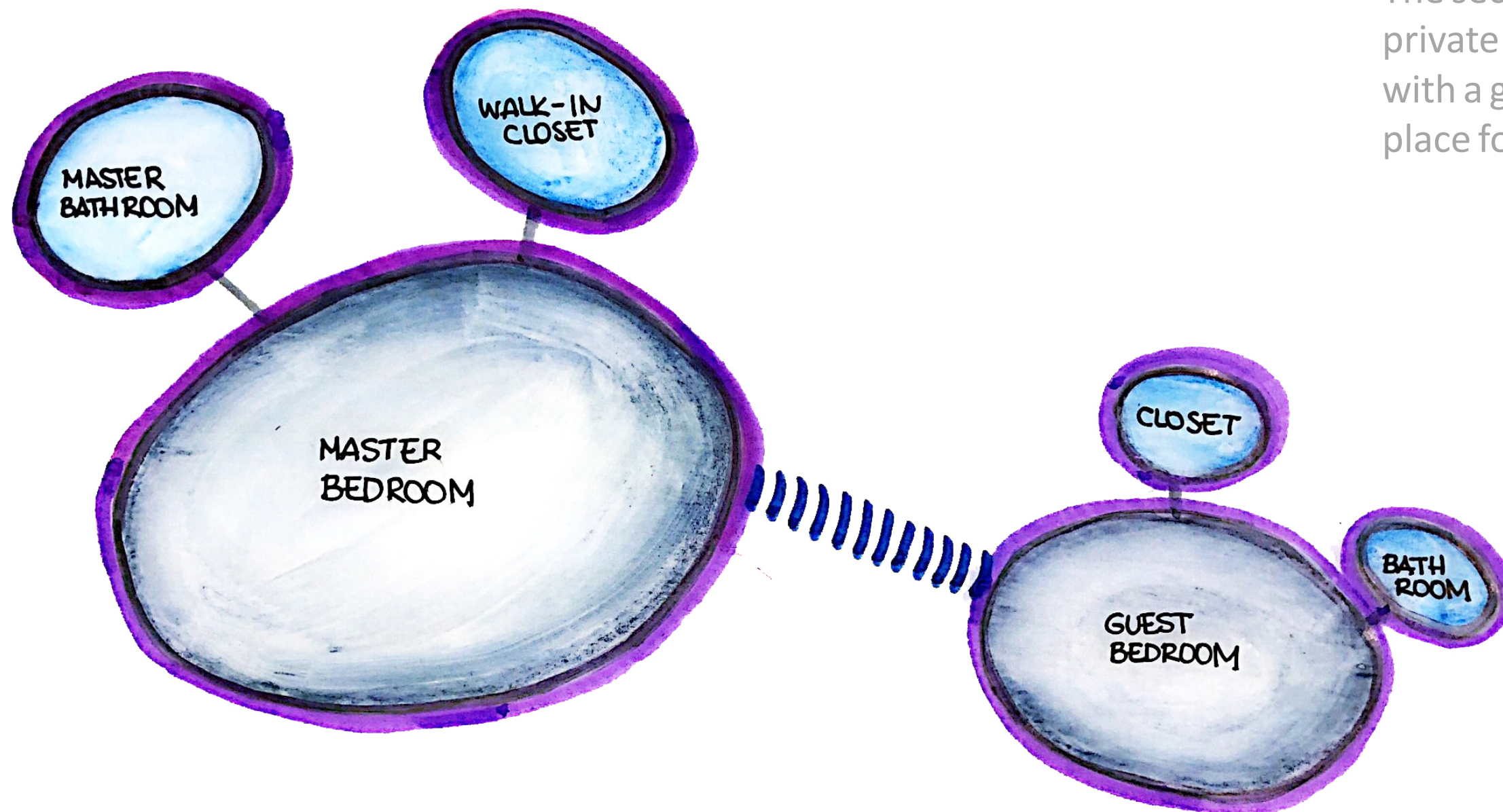

The second floor is a more JUST private area . Even though it counts with a guest bathroom, it is not a place for gathering .

SECOND FLOOR

Public Areas

Private Areas

ADJACENCY DIAGRAM

LIGHT

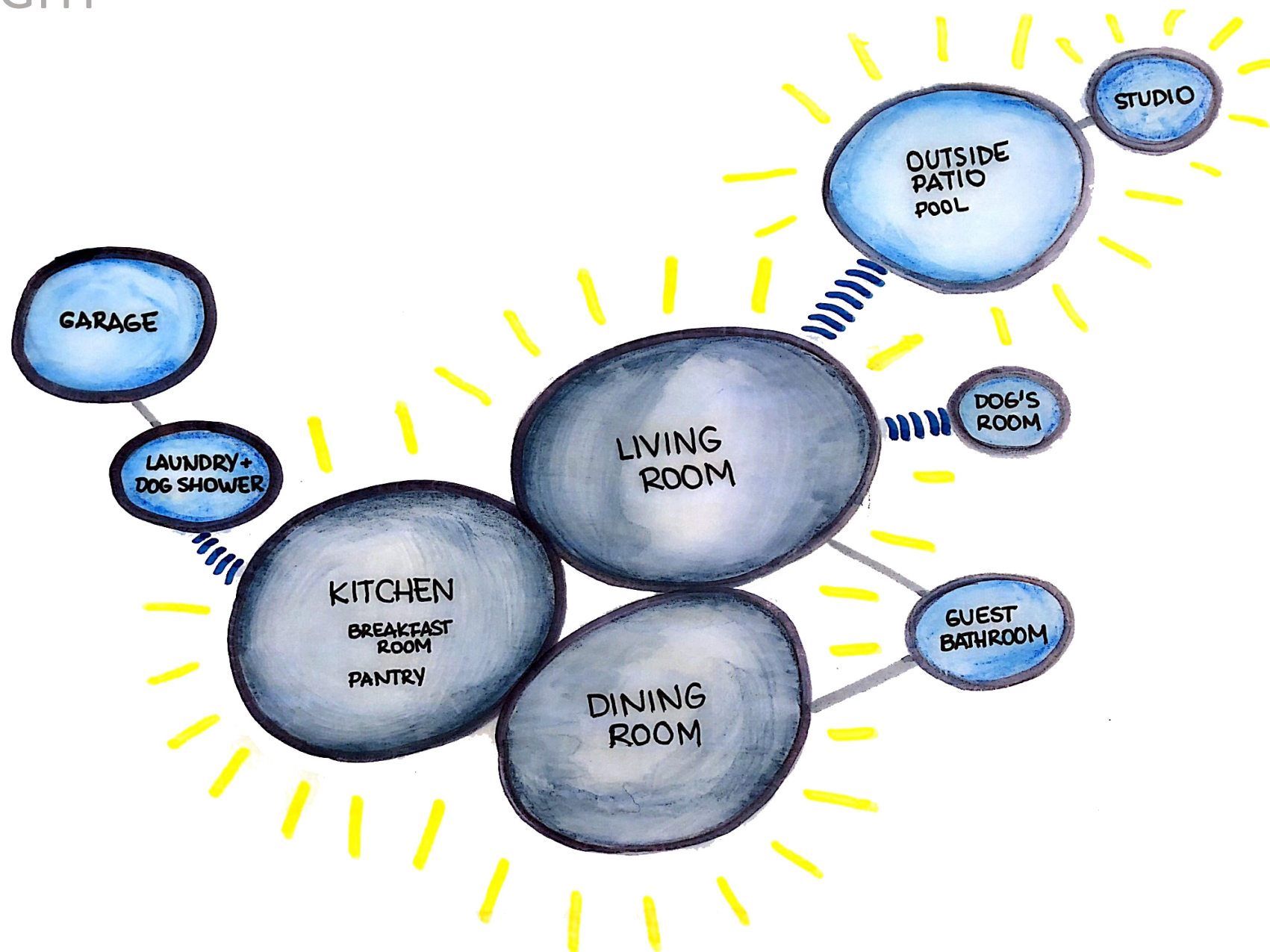

The yellow rays represent the places that need or already count with lots of light, whether is natural or artificial light.

The other spaces are spaces that may count with little or zero natural light because they might not need as much light as the other ones.

FIRST FLOOR

Need of Light

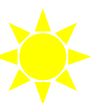

ADJACENCY DIAGRAM

LIGHT

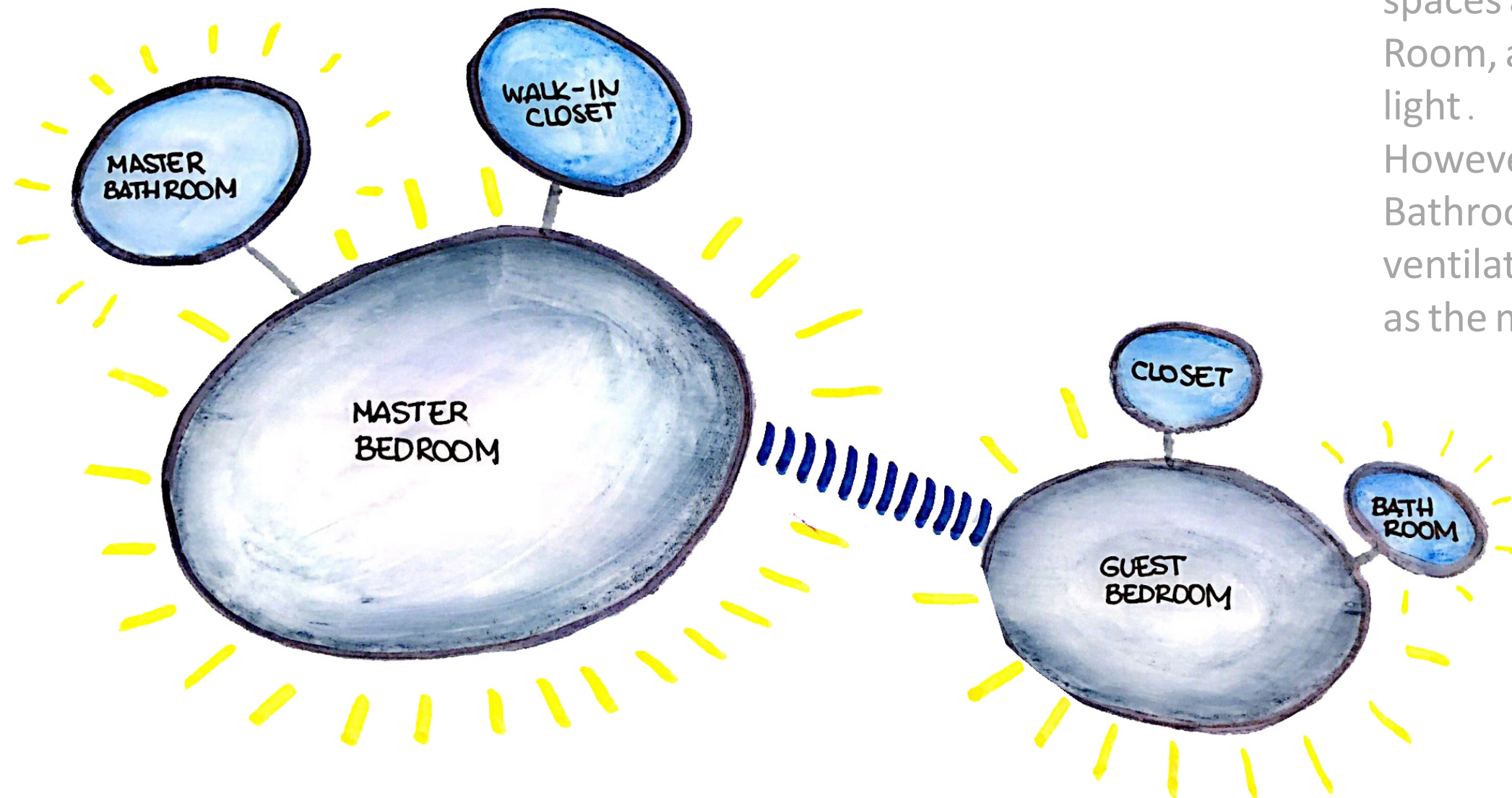

On the second floor, the most important spaces are the Master Room and the Guest Room, and also the ones that need more light.

However, the Master Bathroom, and Guest Bathroom need light, and specially ventilation, they do not need as much light as the main spaces.

SECOND FLOOR

Need of Light

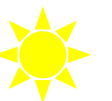

ADJACENCY DIAGRAM

INDIVIDUAL SPACE /
FIRST FLOOR

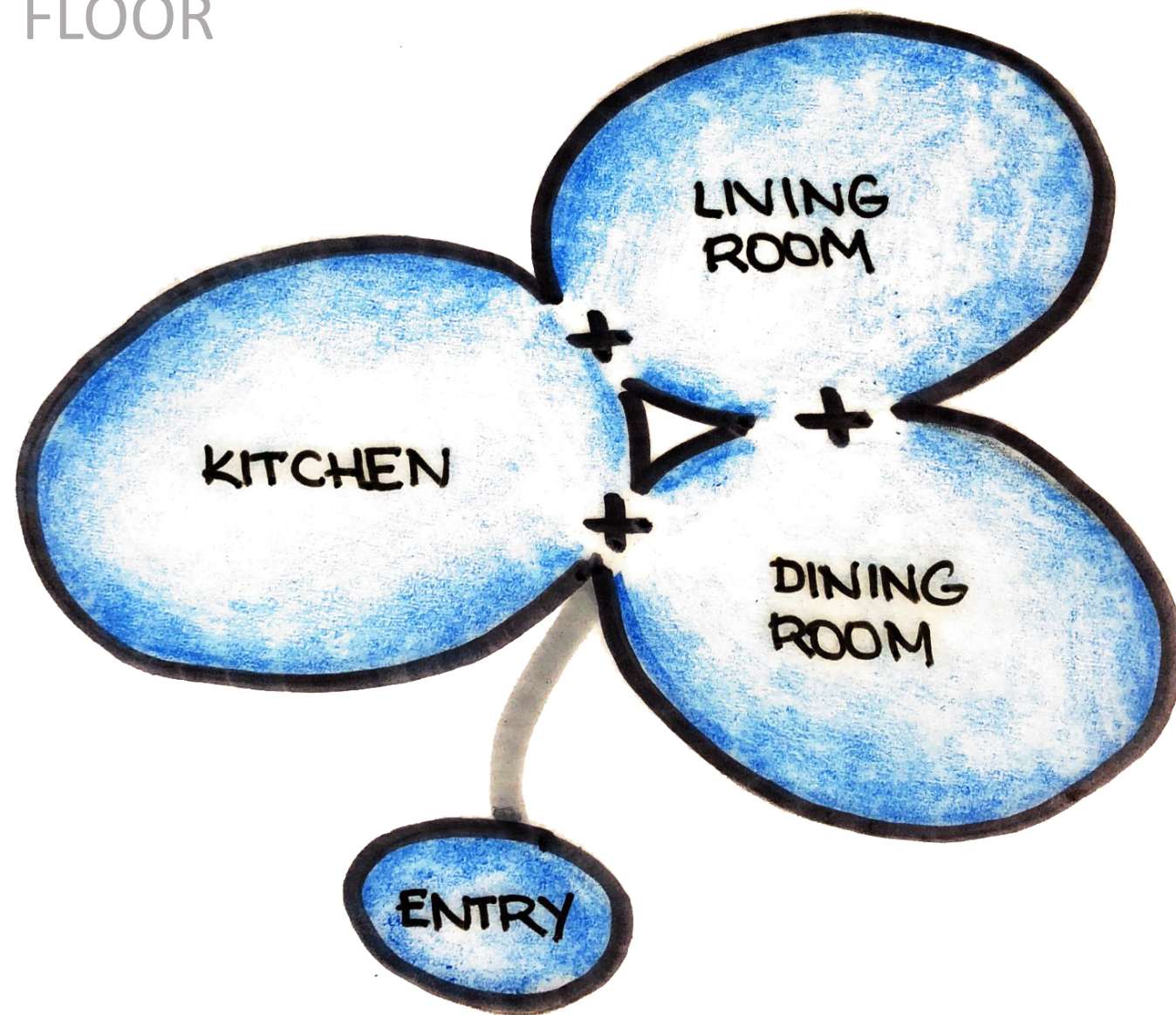
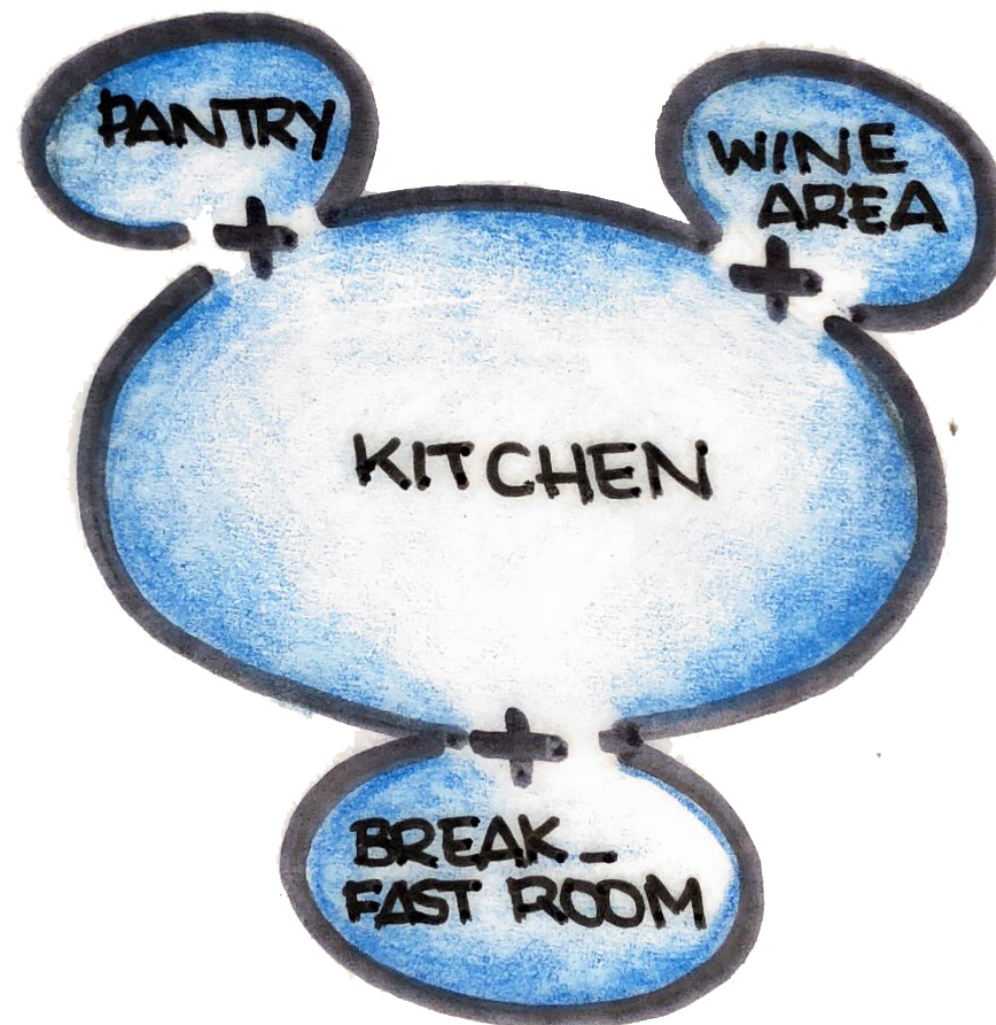

Diagram shows how as soon as a person enters the house, it will lead her /him to the three main spaces of the public part of the house, which are the kitchen, living room, and dining room. Also, it shows the connection between the three spaces.

ADJACENCY DIAGRAM

INDIVIDUAL SPACE /
FIRST FLOOR

Diagram shows the connection between the kitchen (Biggest space), pantry room, wine area, and the breakfast room.



ADJACENCY DIAGRAM

INDIVIDUAL SPACE /
FIRST FLOOR

Diagram shows how to laundry room, mud room, and dog's shower will be located in the same area, and lead to the garage.

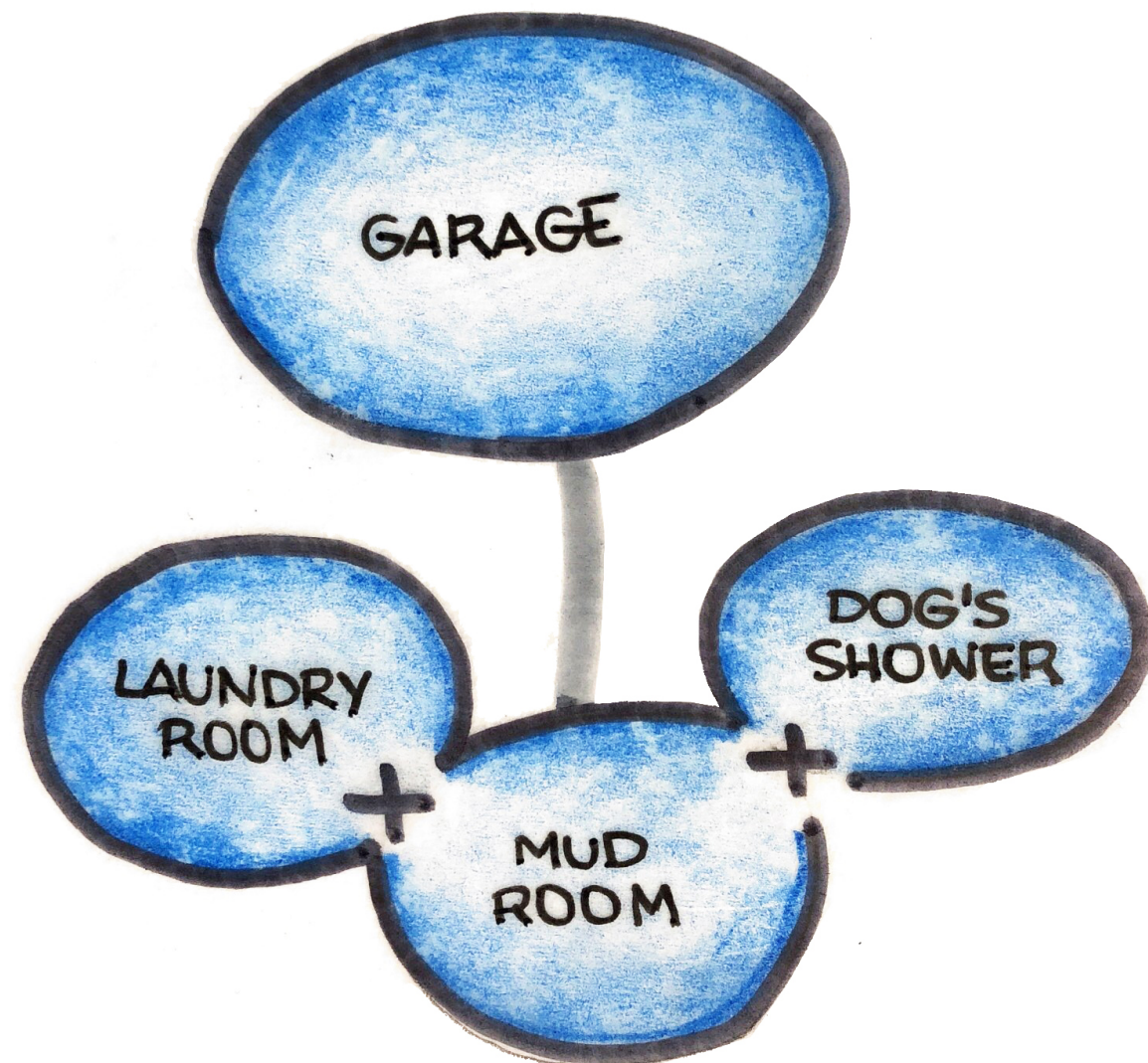

ADJACENCY DIAGRAM

INDIVIDUAL SPACE /
FIRST FLOOR

Diagram shows how the visitors bathroom (1/2) will connect the living room to the dining room. Also, the dog's room will be located in the living room, so the dogs would be close to entrance to greet owners.

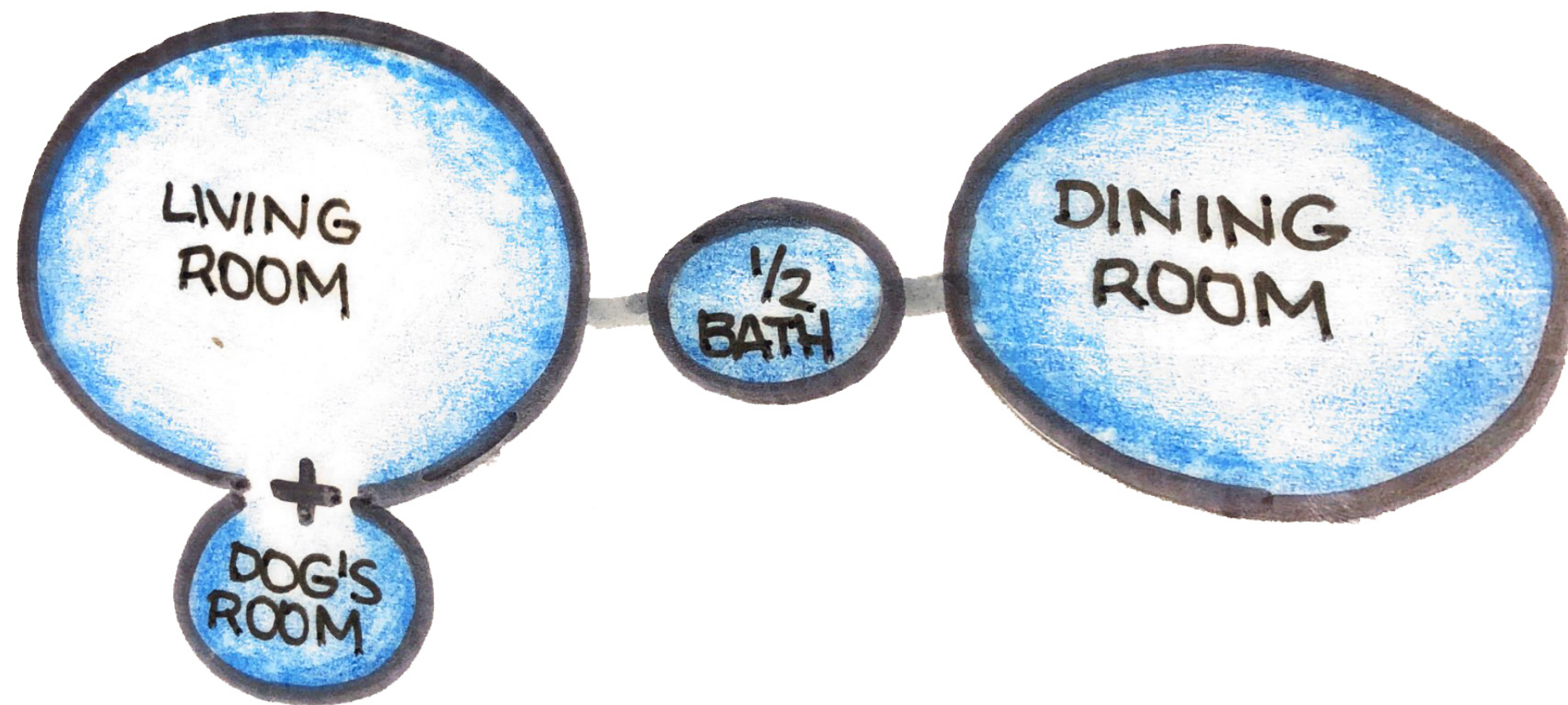

ADJACENCY DIAGRAM

INDIVIDUAL SPACE /
OUTSIDE

Diagram shows how to food garden, and pool would be located on the outside patio, and how this one will serve as a connection to lead to the studio+gallery.

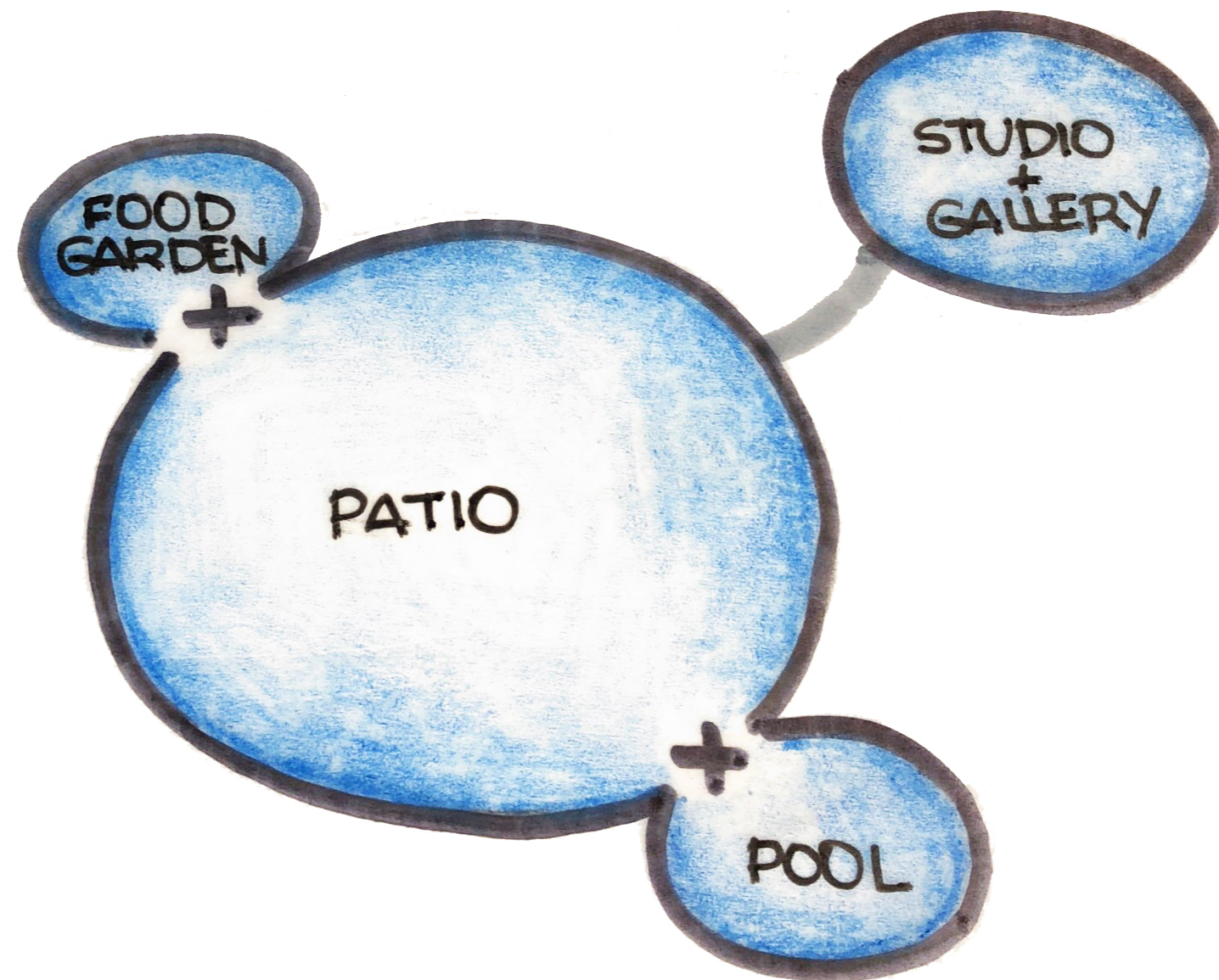

ADJACENCY DIAGRAM

INDIVIDUAL SPACE /
SECOND FLOOR

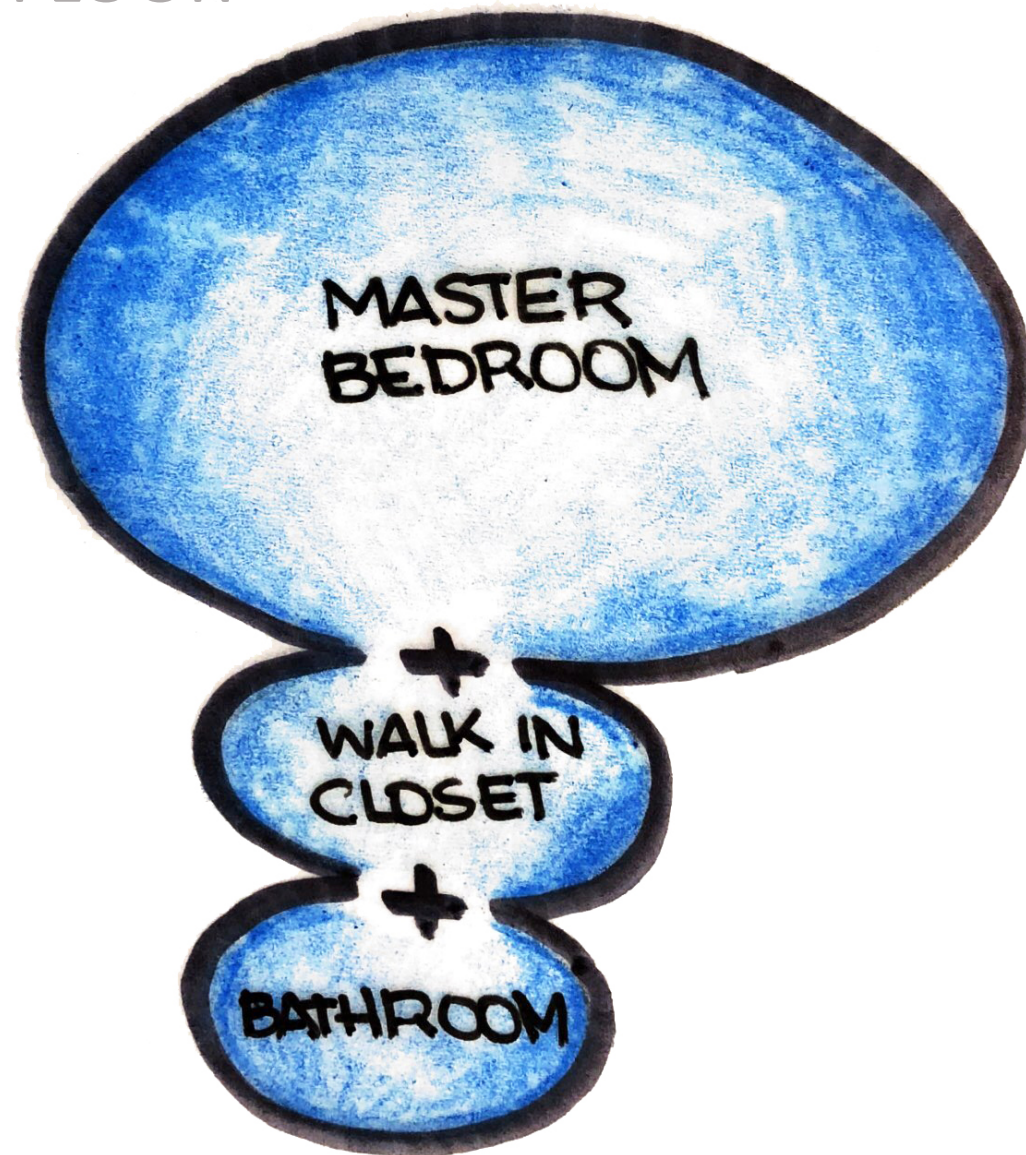
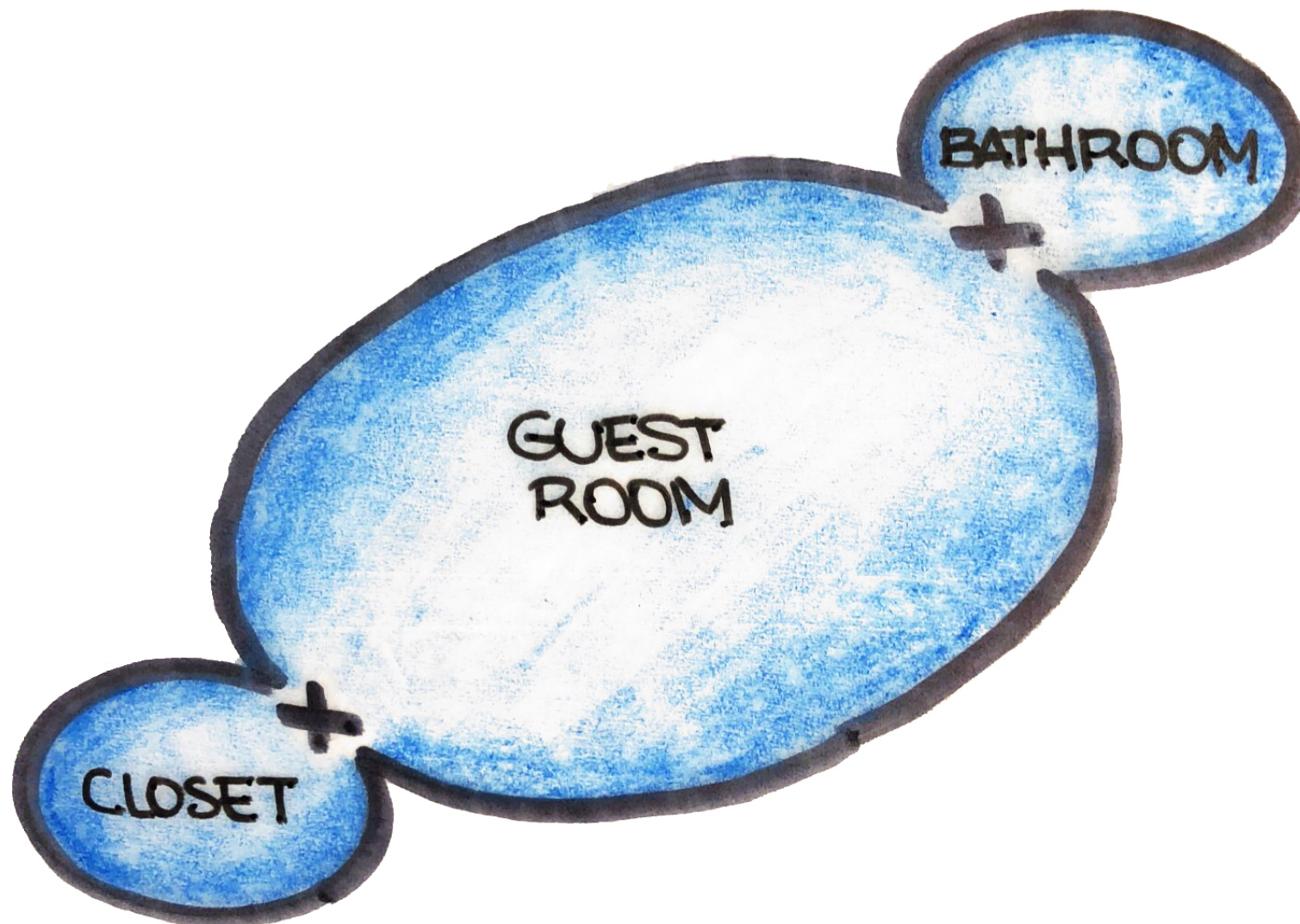

Diagram shows the private parts of the house, and how to Master room will include a walk-in closet, and a master bathroom.

ADJACENCY DIAGRAM

INDIVIDUAL SPACE /
SECOND FLOOR

Diagram shows the private parts of the house, and how the guest room will include a bathroom and a closet.



AREAS

ENTRANCE

Enclose to create some privacy between the outside and inside of the house.

Enough space for a console, and to hand coats if necessary.

Area: 28 sq. ft.

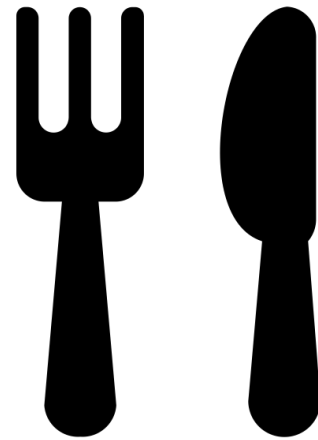
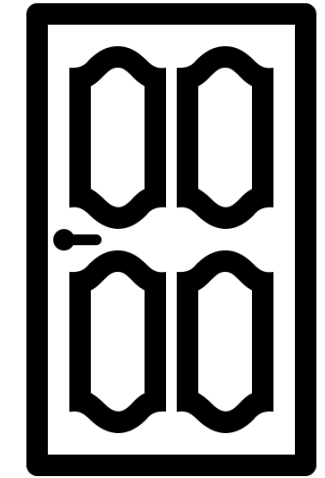

DINING ROOM

Close to the entrance, and with a smooth circulation to the kitchen and living room.

Big space since it is an important feature for client. Close to ½ Bathroom for guests.

Area: 584 sq. ft.

½ BATHROOM

Situated on the first floor of the house, since it will be consider a public space. Enough space for a vanity cabinet, a sink, and a toilette.

Space will count with high window for ventilation.

Area: 58 sq. ft.



AREAS

DOG'S ROOM

Space created under the stairs . Close to the entrance to make it easier for dogs to greet their owners .

Enough space for the two dogs, two beds, and some toys .

Area: 89 sq . ft .

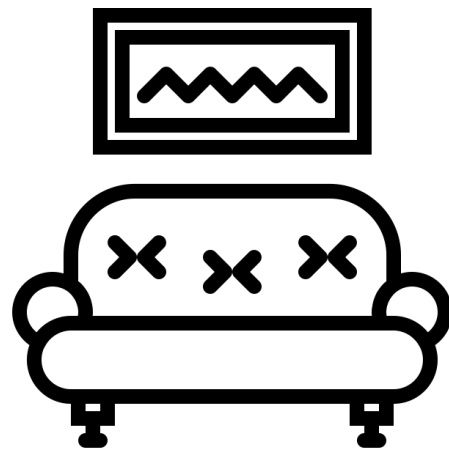

LIVING ROOM

Big space with lots of natural light coming from the patio . High ceiling . Close to ½ bathroom for guests . Accessibility to the patio /pool /food garden /studio . Smooth circulation to kitchen and dining room .

Area: 587 sq . ft .

WINE AREA

Space close to the kitchen and well ventilated to keep wine collection . Enough space for a wine rack, and a console .

Area: 58 sq . ft .



AREAS

KITCHEN

Considered one of the most crucial spaces of the house by the client. Big space with smooth circulation. Lots of natural light and ventilation. Close to Dining and Living Room. Open space since client spends most of the time there.

Area: 590 sq. ft.

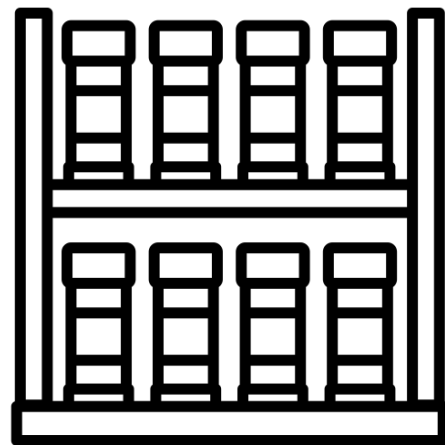
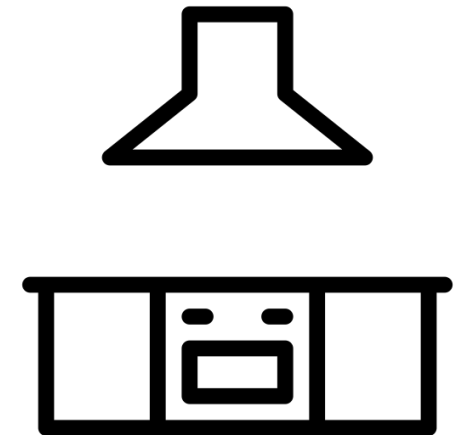

PANTRY ROOM

Space close to the kitchen. Used for storage. Enough space to walk in, and cabinets. Well ventilated.

Area: 45 sq. ft.

BREAKFAST ROOM

Close to kitchen. Usually frequented by the family leaving in the house. Lots of natural light to enjoy breakfast time.

Enough space for a table, chairs, and some cabinets.

Area: 138 sq. ft.



AREAS

GARAGE

Space connected to the outside of the house . Enough space for two cars and some racks for storage .

Area : 387 sq . ft .

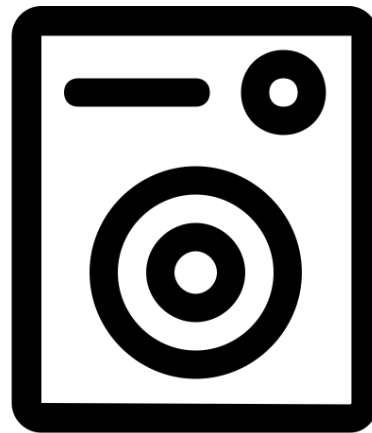
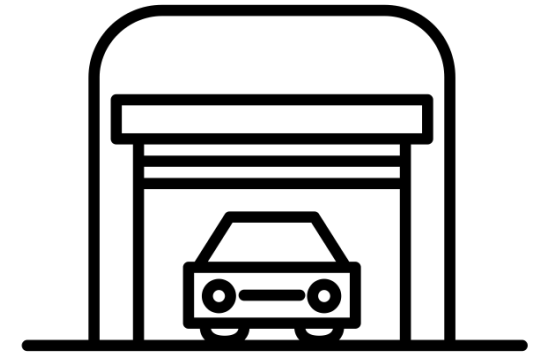

LAUNDRY + MUD ROOM

Space between garage and kitchen . Enough space for a dryer, washer, and ironing station . Hangers for wet clothes in case of raining outside .

Area : 98 sq . ft .

DOG'S SHOWER

Situated next to laundry room, between garage and kitchen . Space created for the dogs .

Enough space for a elevated shower .

Area : 54 sq . ft .



AREAS

PATIO + POOL

Public part of the house . Outside space with green and concrete areas to allow space patio furniture . Smooth circulation and connection to the inside of the house .

Area: 4554 sq. ft.



FOOD GARDEN

Part of the green areas of the patio . Very important space for client to be able to have fresh vegetables .

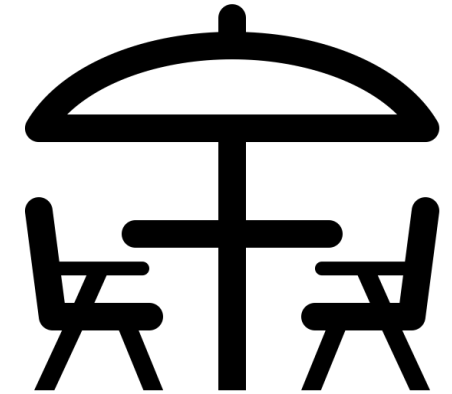

STUDIO + ART GALLERY

One of the most important spaces for client . Situated outside the house for more privacy .

Enough space to create art, and to storage it .

Area: 426 sq. ft.

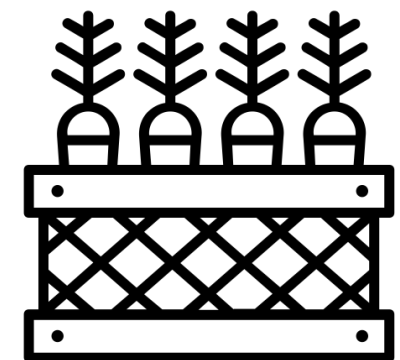

AREAS

MASTER BEDROOM

Second floor, private part of the house . Big space with natural light and view to the ocean .

Space for king bed, and furniture .

Area: 404 sq. ft.

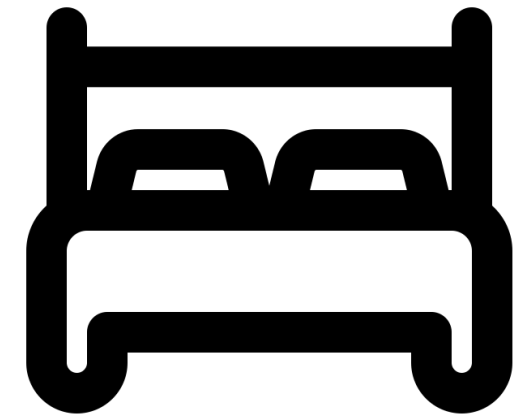
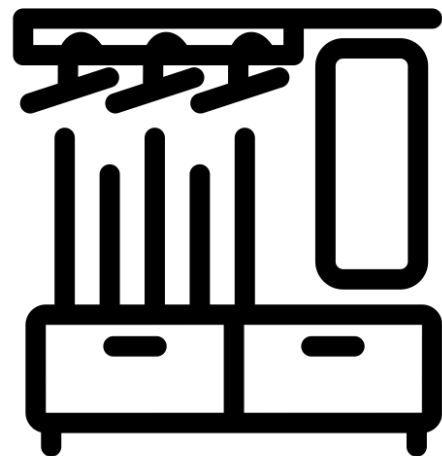

WALK IN CLOSET

Big closet that would serve as storage for both clients .
Serve as connection between master room and bathroom .
Enough space for furniture, hangers, and mirrors .

Lots of artificial light for better vision .

Area: 180 sq. ft.

MASTER BATHROOM

Biggest bathroom of the house with windows that allow natural light and ventilation . Enough space for two vanity cabinets, two sinks, big shower, toilet and Jacuzzi .

Area: 258 sq. ft.

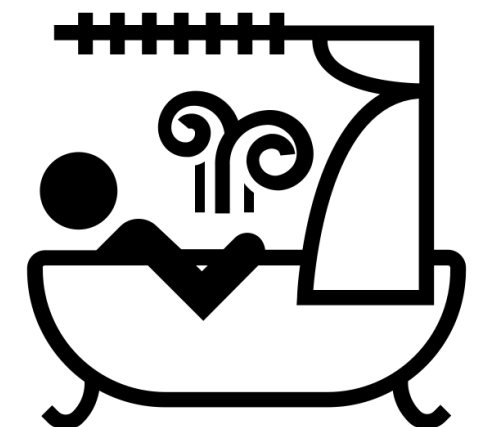

AREAS

GUEST BEDROOM

Second floor of the house, private area . Bedroom created for guests to stay over . Big area with enough space for a bed, furniture . Will count with a bathroom and a little walk in closet.

Area: 400 sq. ft.



CLOSET

Situated inside the guest bedroom in case guest would stay for a long period of time . Enough space for a person to walk inside, hangers and some furniture .

Area: 50 sq. ft.

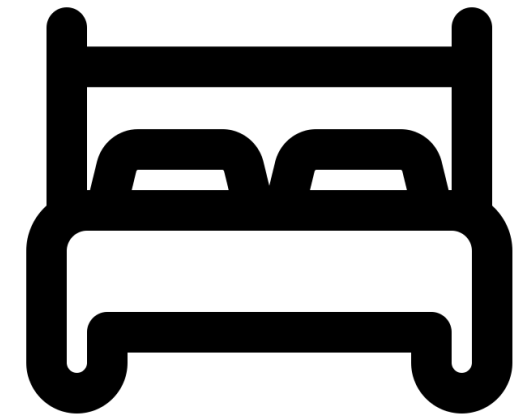

GUEST BATHROOM

Situated inside the guest bedroom . Smaller bathroom compared to the master one . Enough space for a shower, vanity cabinet, a sink, and a toilet .

Area: 102 sq. ft.

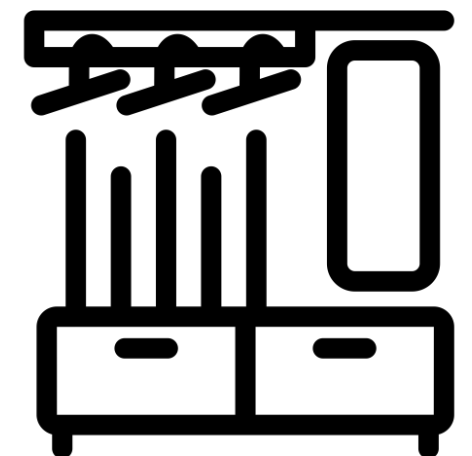

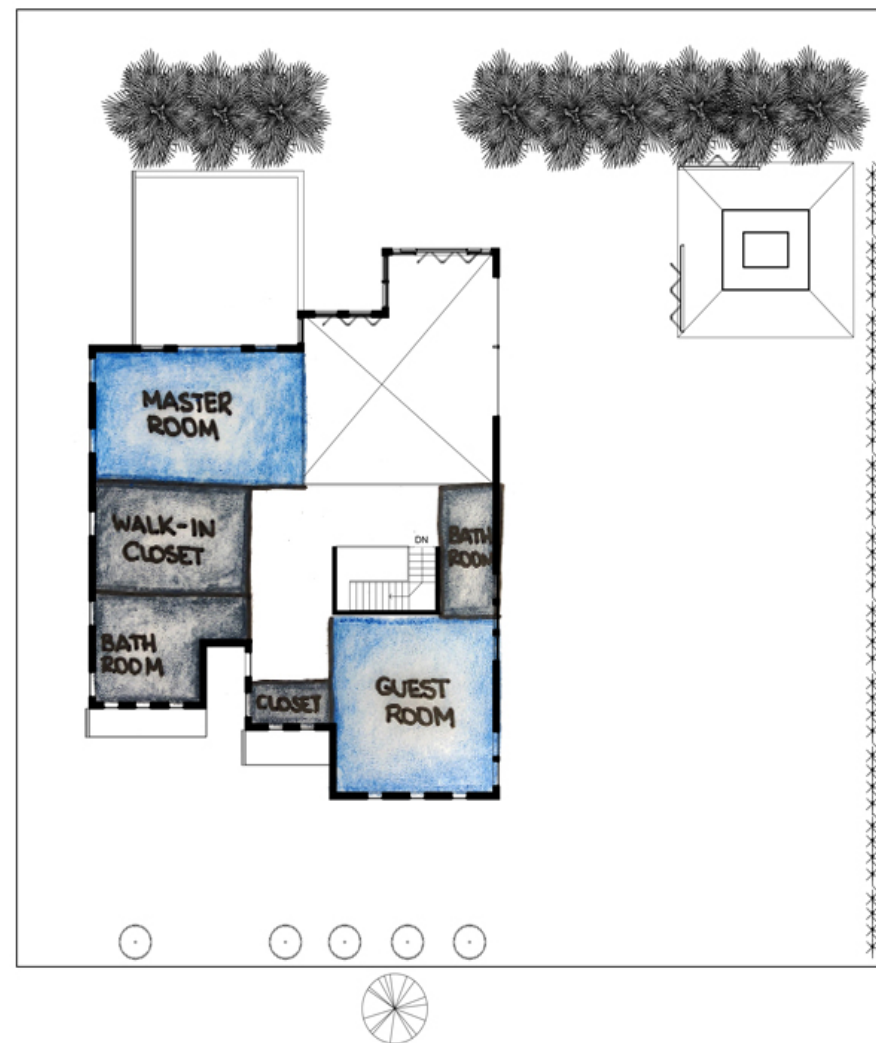

First Floor:

Kitchen
Living Room
Dining Room
Entrance
Breakfast Room
Pantry Room
Space for Wine Collection
Laundry Room
Mud Room

Dog Shower
Garage
Dog's Room
1/2 Bathroom
Patio
Vegetable Garden
Pool
Studio + Gallery

Second Floor:

Master Bedroom
Walk-In Closet
Master Bathroom
Guest Room
Closet
Bathroom

Larger Spaces 
Smaller Spaces 

FIRST AND SECOND FLOOR

BLOCKING DIAGRAM

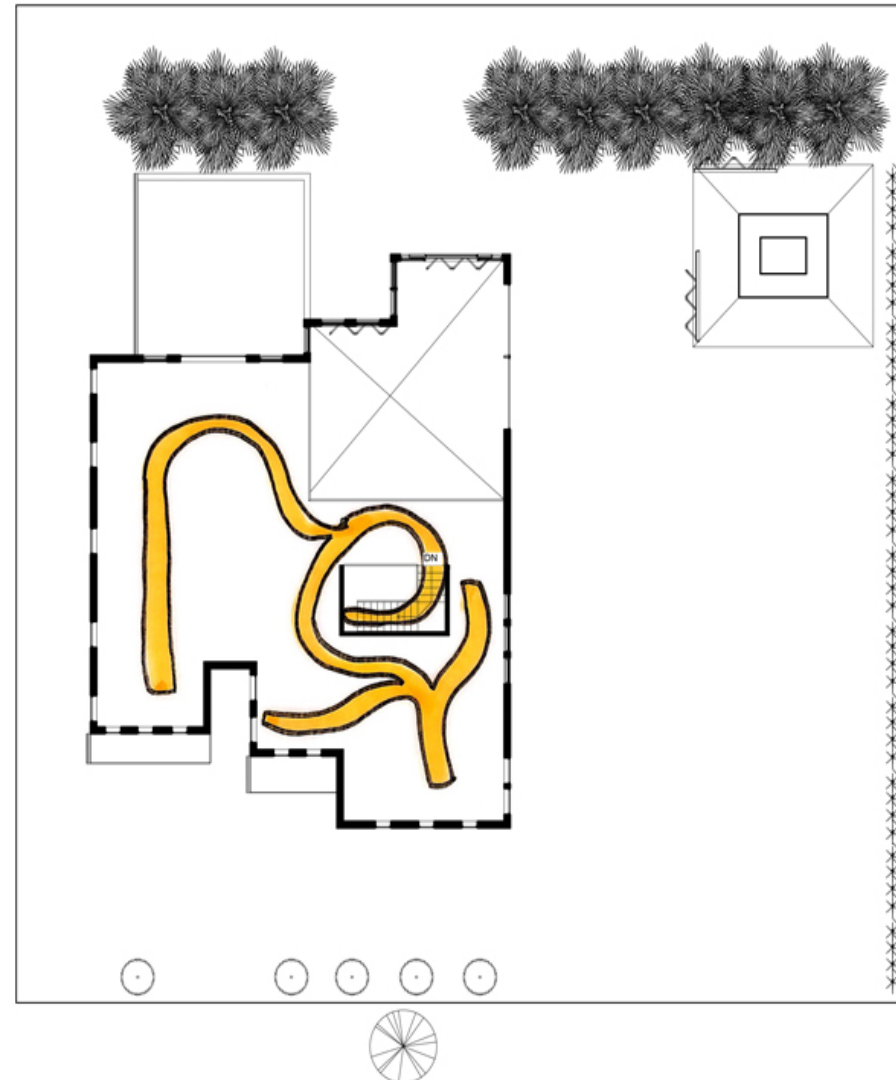
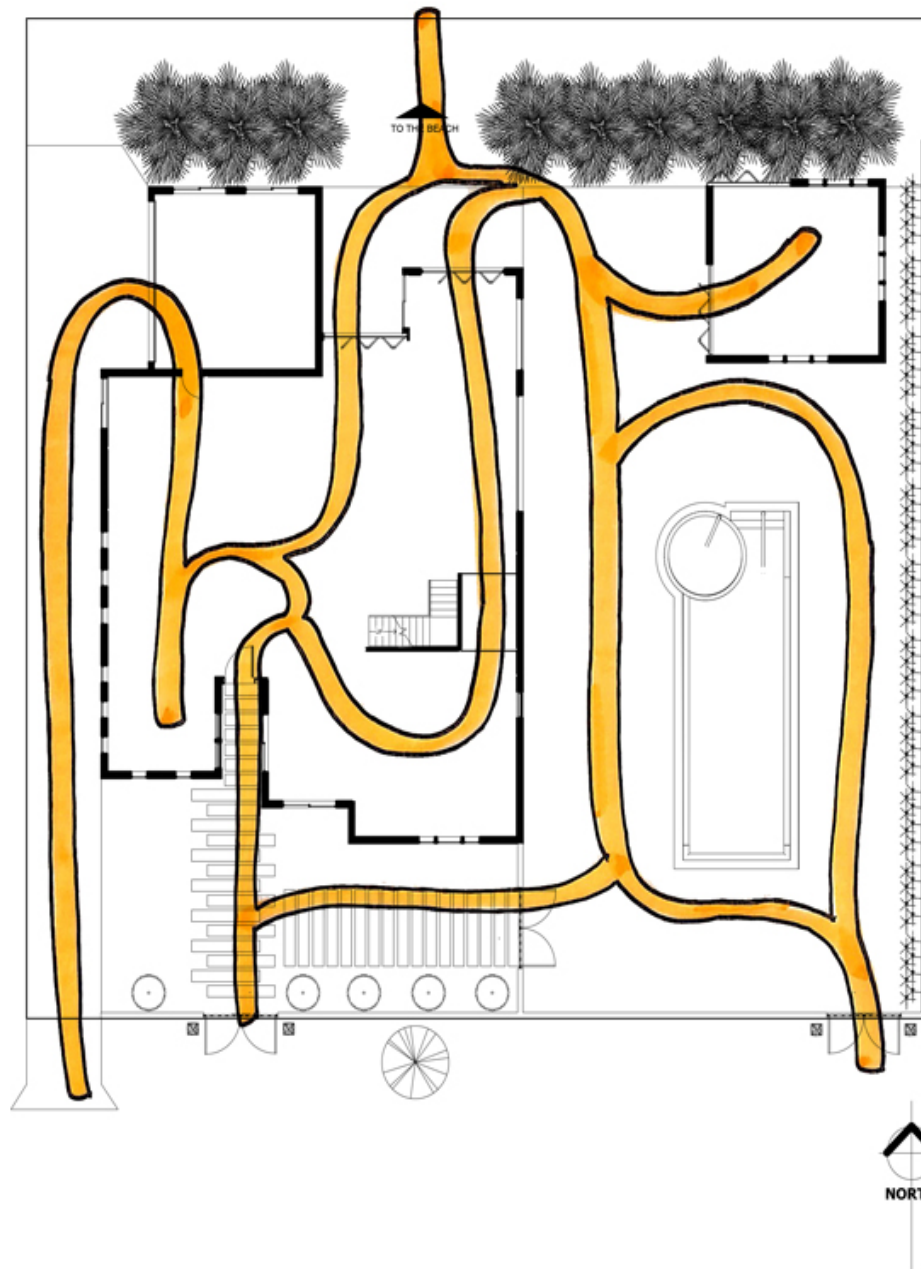

GOAL:
Create a smooth circulation within the areas inside
the house, and the ones outside the house .

FIRST AND SECOND FLOOR

CIRCULATION DIAGRAM

DESIGN GUIDELINES

In order to...

Achieve the “Dream house” for the clients, I would create an open plan that would be ideal for accessibility, would make spaces look larger, would make the transmission of air and light more effective, and would reduce construction cost.

Paying attention to the clients needs depending on the hobbies is a crucial aspect for this design . I would create a big kitchen, with smooth circulation, and a pantry room . A food garden, so the client would be able to have access to fresh food at any time of the day . Also, a studio /gallery situated outside the house to have more privacy, and a wine area to be able to keep their wine collection and close to living room to be able to share it with guests .

Another crucial aspect of this design will be the presence of the two dogs and to create space for both to give the feeling that they are part of the family . Creating a space for them to rest, shower and eat .

Since the clients have a “free spirit”, I want to create a space with natural elements, and colors find in nature To block the light without covering the windows in order to have a great view to the outside, I would use high trees in order to cover the house from light and to use them as a barrier for noise .

REFERENCES

- The Noun Project
www.thenounproject.com